

**1.2± Acre Commercial Lot
MADISON COUNTY, MS
167 Lakeview Drive Madison, MS 39110**



\$100,000

Approximately 1.2+/- acre Madison County property, zoned C1, featuring picturesque water views just across I55 from Sam's. The property features an older residential structure that can no longer be used for residential use and must be converted into office space or demolished. With its prime location, this property would be an ideal waterfront office or medical building near the Baptist Madison Campus, offering abundant potential for development. Call Allyson to schedule your tour today!



**ALLYSON
MIZE**
REALTOR®

Office: 601.898.2772
Cell: 662.607.1703
Allyson@TomSmithLand.com



A Real Estate Expert You Can Trust

TomSmithLandandHomes.com

Information is believed to be accurate but not guaranteed.





Call me today!

ALLYSON MIZE, REALTOR*
Allyson@TomSmithLand.com
601.898.2772 office | 662.607.1703 cell



TomSmithLandandHomes.com

Information is believed to be accurate but not guaranteed.



AERIAL MAP

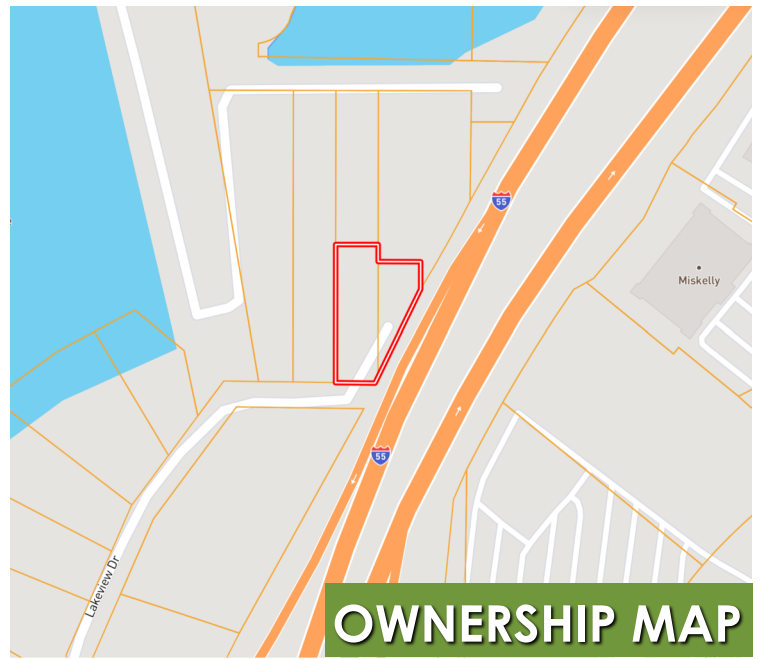

OWNERSHIP MAP

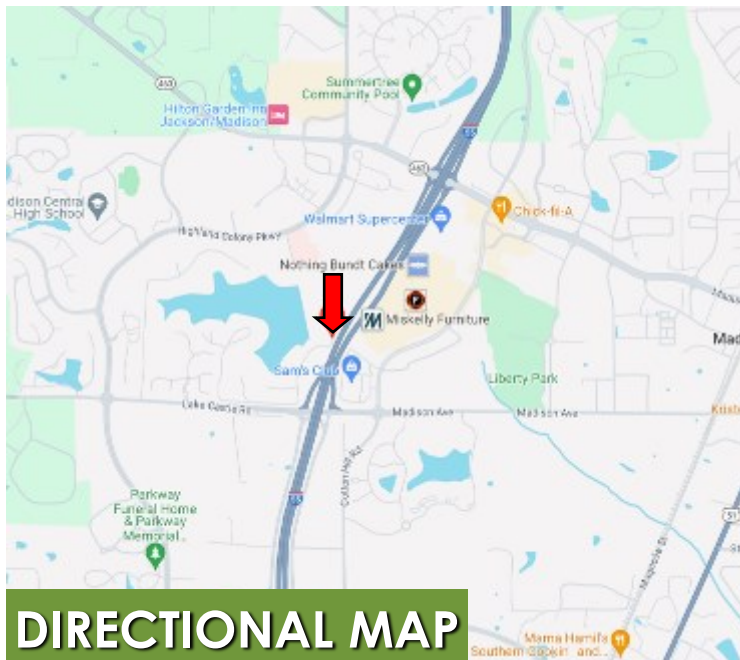

DIRECTIONAL MAP

Directions from I-55 and Madison Avenue in Madison, MS: Take exit 107 and merge onto Madison Avenue/Lake Castle Rd. Travel .4 miles, then turn right onto Lakeview Drive. After .5 miles, the property will be on your left.

[Google Map Link](#)
[Click Here for a Landid Interactive Map](#)



**ALLYSON
MIZE**
REALTOR®
Office: 601.898.2772
Cell: 662.607.1703
Allyson@TomSmithLand.com



A Real Estate Expert You Can Trust

TomSmithLandandHomes.com

Information is believed to be accurate but not guaranteed.

