



McCool West Tract

Echola Community, Tuscaloosa County, AL

Timberland / Recreation / Hunting

135 +/- Acres

NEW PRICE! \$367,875.00

Section 5 and 6, Township 20 South, Range 12 West

33.3418 -87.8191

P. O. Box 600

Gordo, AL 35466

205-364-7145

For more info: www.midsouthforestryservices.com

Dale Lancaster, Broker

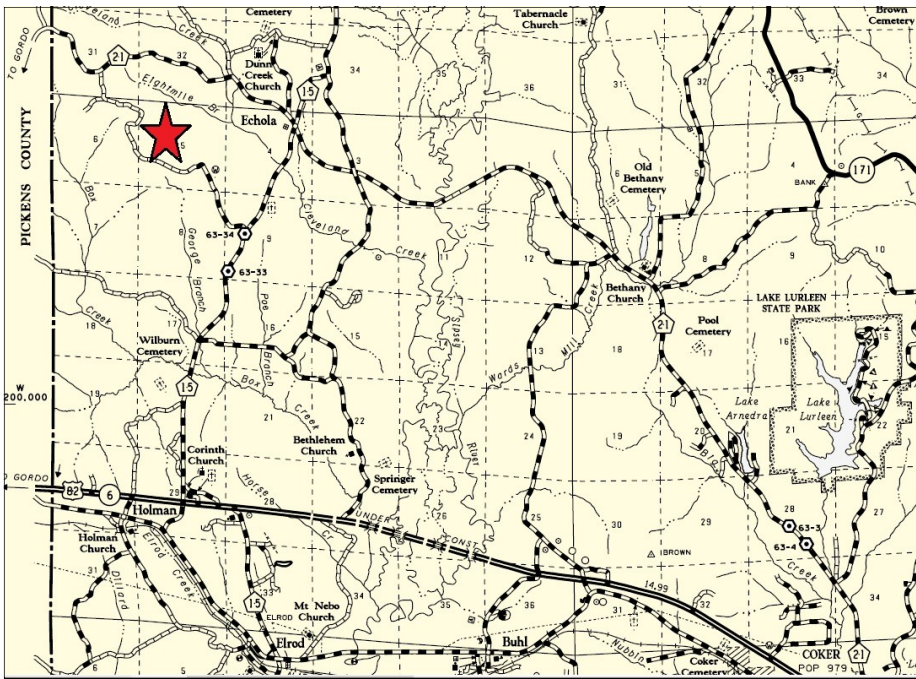

135 +/- acres of timberland and recreational land located in western Tuscaloosa County in the Echola Community. Located on Hatter Road within 8 miles of Gordo and only 18 miles to Northport, this is a great tract for hunting/recreational activities and future timber income. With frontage on Hatter Road and a good interior road system, this property is very accessible. Property consists of established food plots, 88 +/- acres of pine plantation established in 2019, 3 +/- acres of pine plantation established in 2006, and 44 +/- acres of mixed hardwoods and pine in Streamside Management Zones. The adjoining property is also available for sale if you desire a larger tract!



All information furnished is assumed to be accurate and correct. However, neither the property owner nor Midsouth Forestry Services warrant the accuracy of information furnished. Prospective buyers should satisfy themselves as to the accuracy of this information. No representation or warranties are expressed or implied as to the property, its condition, boundaries, access, acres, zoning, condition of title or fair market value.