

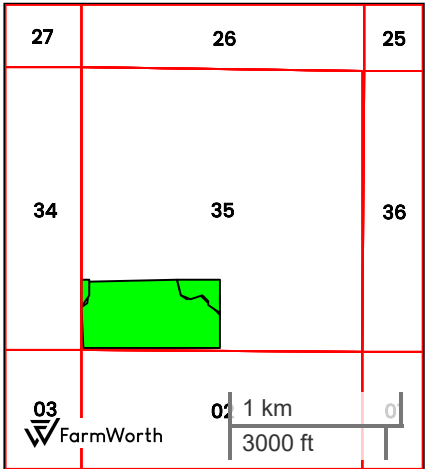

UNDEFINED FARM (80.00 AC TOTAL, 76.53 AC TILLABLE)  
TILLABLE SOILS

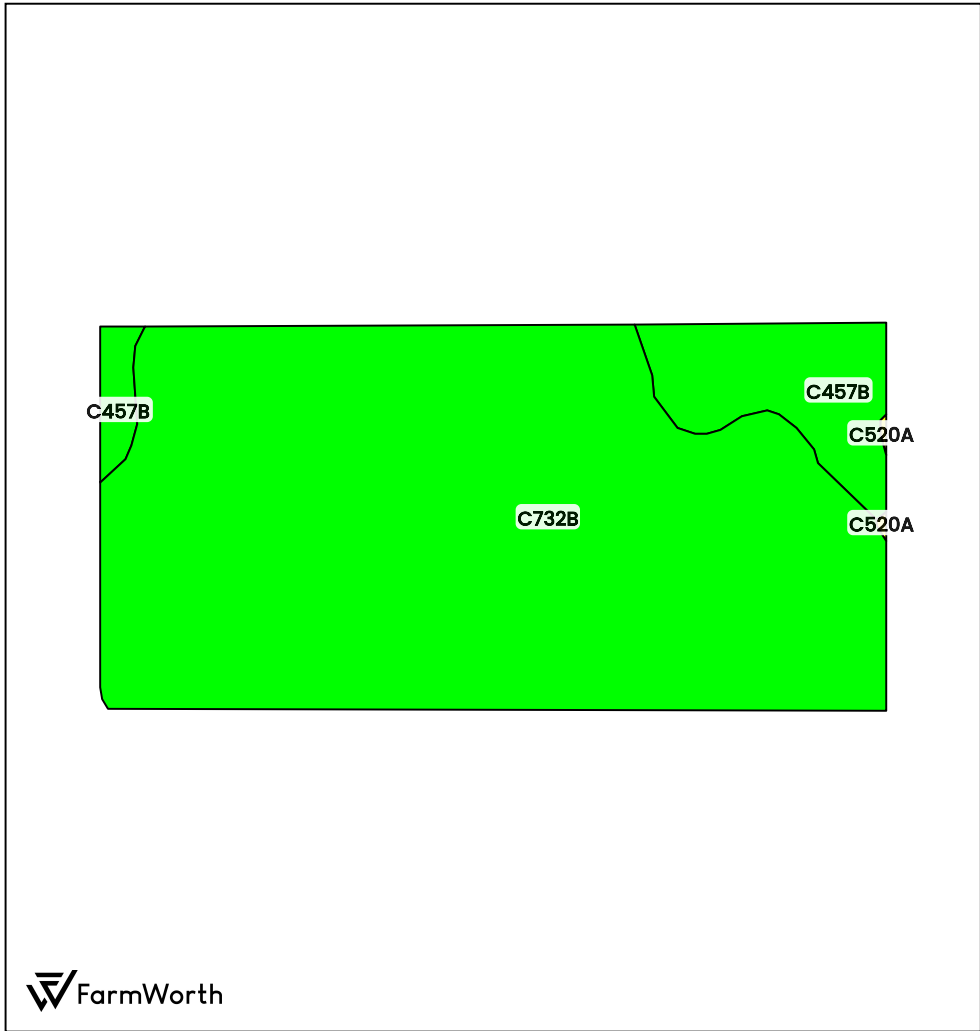



County: **Emmons County, ND**  
Location: **35-130N-77W**  
Township: **South Emmons UT**  
Acres: **76.53**  
Date: **07/25/2024**



Field borders obtained from Farm Service Agency  
as of 2008

FarmWorth, LLC makes no representations or warranties, express or implied, as to the accuracy of any information, data, numerical values, boundaries, or any other information generated through the use of FarmWorth.com. User is solely responsible for independently investigating and determining all information provided through FarmWorth.com prior to use and waives any and all claims against FarmWorth, LLC for any inaccuracies or inconsistencies in the information and/or data.

Code	Description	Acres	% of field	CPI	Soil Class (Non-Irr)	Drainage Class
C732B	 Bryant silt loam, 2 to 6 percent slopes	68.02	88.88 %	81	2	Well drained
C457B	 Grassna silt loam, 2 to 6 percent slopes	8.44	11.03 %	90	2	Well drained
C520A	 Belfield-Daglum complex, 0 to 2 percent slopes	0.07	0.09 %	65	2	Moderately well drained
				<b>Average:</b>	<b>82.0</b>	

Crop Productivity Index tables for ND and SD are obtained from SSURGO using weighted average of all components within the soil profile  
Soils data provided by USDA and NRCS.