



## SUBSURFACE SEWAGE DISPOSAL SYSTEM PERMIT DISCLOSURE

Regarding: 146 Garden Drive Lafayette TN 37083  
PROPERTY ADDRESS

The owner of this residential property discloses the following:

☒ According to the subsurface sewage disposal system permit issued for this property, this property is permitted for 4 (number of) bedrooms. A copy of the permit was obtained from the appropriate governmental permitting authority and is attached to this disclosure.

☐ I/We have requested a copy of the subsurface sewage disposal system permit issued for this property from the appropriate governmental permitting authority. However, I/we were informed that

☐ The file could not be located.

OR

☐ A permit was not issued for this property.

As a result, I/we do not have any knowledge as to the number of bedrooms for which this property has been permitted.

**NOTE:** There may be additional information which may be of interest and/or concern to Buyers contained in the official file with the Tennessee Department of Environment and Conservation, Groundwater Protection division located in the county office regulating septic systems. This file may contain information concerning maintenance that has been done on the system as well as any violations imposed by the state. Buyers are encouraged to obtain this information and if of concern to them, to have a soil engineer interpret the contents of the file. Real estate licensees are not soil engineers and are not experts who can provide an interpretation of the contents of the official file.

The following parties have reviewed the information above and certify, to the best of their knowledge, that the information they have provided is true and accurate and acknowledge receipt of a copy:

The party(ies) below have signed and acknowledge receipt of a copy.

BUYER

BUYER

\_\_\_\_\_ at \_\_\_\_\_ o'clock ☐ am/ ☐ pm  
Date

\_\_\_\_\_ at \_\_\_\_\_ o'clock ☐ am/ ☐ pm  
Date

The party(ies) below have signed and acknowledge receipt of a copy.

☒   
SELLER David Hutcheson

SELLER \_\_\_\_\_

☒ \_\_\_\_\_ at \_\_\_\_\_ o'clock ☐ am/ ☐ pm  
Date

\_\_\_\_\_ at \_\_\_\_\_ o'clock ☐ am/ ☐ pm  
Date

*NOTE: This form is provided by Tennessee REALTORS® to its members for their use in real estate transactions and is to be used as is. By downloading and/or using this form, you agree and covenant not to alter, amend, or edit said form or its contents except as where provided in the blank fields, and agree and acknowledge that any such alteration, amendment or edit of said form is done at your own risk. Use of the Tennessee REALTORS® logo in conjunction with any form other than standardized forms created by Tennessee REALTORS® is strictly prohibited. This form is subject to periodic revision and it is the responsibility of the member to use the most recent available form.*

This form is copyrighted and may only be used in real estate transactions in which Mrs. Debra Dodd is involved as a Tennessee REALTORS® authorized user. Unauthorized use of the form may result in legal sanctions being brought against the user and should be reported to Tennessee REALTORS® at 615-321-1477.





TENNESSEE DEPARTMENT OF ENVIRONMENT AND CONSERVATION  
APPLICATION FOR GROUND WATER PROTECTION SERVICES

1. SERVICE REQUESTED: (check service)	APPLICANT COMPLETE QUESTIONS:	FEES DUE	PTBMIS CODES V689 Code Supp/Code	
<input type="checkbox"/> Septic System Construction Permit				
<input type="checkbox"/> Dwelling	2, 3, 4, 7, 8, 9	\$	78064	Yes
<input type="checkbox"/> Commercial: gpd	2, 3, 4, 7, 8, 9	\$	78064	Yes
<input type="checkbox"/> System Modification	2, 3, 4, 7, 8, 9	\$	78064	Yes
<input checked="" type="checkbox"/> Repair	2, 3, 4, 7, 8, 9	\$ 100.00		
<input type="checkbox"/> Inspection Letter	2, 3, 5, 7, 8, 9	\$	78030	
<input type="checkbox"/> Certificate of Verification	2, 3, 5, 7, 8, 9	\$	78032	Yes
<input type="checkbox"/> Water Sample				
<input type="checkbox"/> Total Coliform	2, 3, 6, 7, 8, 9	\$	78036	Yes
<input type="checkbox"/> Fecal Coliform	2, 3, 6, 7, 8, 9	\$	78038	Yes
<input type="checkbox"/> Alternative System Permit*		\$	78068	
<input type="checkbox"/> Large Conventional System Plan Review*		\$	78090	
<input type="checkbox"/> Large Alternative System Plan Review*		\$	78090	
<input type="checkbox"/> Experimental System Plan Review*		\$	78072	
<input type="checkbox"/> Subdivision Evaluation: Lots: *		\$	78084	
<input type="checkbox"/> Soil Mapping: Type _____ Acres _____ *		\$		Yes
<input type="checkbox"/> Installer Permit: Type(s) _____ *		\$	78026	Yes
<input type="checkbox"/> Pumper Permit*		\$	78028	
<input type="checkbox"/> Plat Approval — Individual Lot		\$	78029	
<input type="checkbox"/> Domestic Septage Disposal Site Permit		\$	78031	

\*Applicant may review these service requests with Environmental Specialist prior to processing application.

2. LANDOWNER:	APPLICANT	ORIGINAL OWNER
Names: <u>Scabrina Branner</u>	Name: <u>James King</u>	Name: _____
Address: <u>Phillips Hollow Road</u>	Address: <u>155 Kings Hill Road</u>	
<u>Westmoreland TN</u>	<u>LAFAYETTE TN 37083</u>	
Day Phone: <u>(615) 644-4191</u>	Day Phone: <u>(615) 362-0028</u>	

3. LOCATION OF LOT OR SITE: a) In a subdivision? \_\_\_\_\_ b) Name: 146 Garden Drive LAFAYETTE Lot # \_\_\_\_\_  
b) Non-Subdivision \_\_\_\_\_ Give specific directions and address to the lot or site: \_\_\_\_\_

4. FOR SSDS PERMIT ONLY: a) Size of lot \_\_\_\_\_ b) Number of Bedrooms \_\_\_\_\_  
c) How many occupants? 4 d) Excavated Basement? Yes \_\_\_\_\_ No \_\_\_\_\_  
e) Basement Plumbing Fixtures? Yes \_\_\_\_\_ No \_\_\_\_\_  
f) Amount of water used monthly (gallons) \_\_\_\_\_  
g) Water Supply: Public \_\_\_\_\_ Well \_\_\_\_\_ Spring \_\_\_\_\_  
h) Is the lot staked? \_\_\_\_\_ If not, date it will be staked: \_\_\_\_\_  
Is the house staked? \_\_\_\_\_ If not, date it will be staked: \_\_\_\_\_  
i) Installer, if known: \_\_\_\_\_

5. FOR INSPECTION LETTER ONLY: Will pick up \_\_\_\_\_ Please mail \_\_\_\_\_  
a) Age of house \_\_\_\_\_ b) Is house vacant? \_\_\_\_\_ How long? \_\_\_\_\_  
c) Original sewage system inspected \_\_\_\_\_  
d) Date of previous repairs \_\_\_\_\_ Inspected \_\_\_\_\_  
e) Is waste water "backing up" into plumbing fixtures? \_\_\_\_\_ Surfacing on the ground? \_\_\_\_\_  
f) All waste water including washing machines routed into septic tank \_\_\_\_\_

6. FOR WATER SAMPLE ONLY: a) Source of Supply: Spring \_\_\_\_\_ Well \_\_\_\_\_  
b) Is there an outside faucet? \_\_\_\_\_ c) Is the source chlorinated? \_\_\_\_\_  
d) For Wells: Is the casing 6" above the ground? \_\_\_\_\_ Is a sanitary seal on the casing? \_\_\_\_\_

7. MAKE A ROUGH SKETCH ON BACK OF THIS WHITE PAGE SHOWING DIRECTIONS TO PROPERTY, PROPERTY LINES, HOUSE SITE, WELL LOCATION, SPRING LOCATION, PLANNED DRIVEWAY AND UTILITIES.

8. ALL FEES DUE IN ADVANCE AND ARE NON-REFUNDABLE (except upon appeal). See Fee Schedule on reverse. Make check payable to: **TREASURER, STATE OF TENNESSEE**

9. I certify that the above information is true and correct to the best of my knowledge, and that I have been authorized by the above named landowner to submit this Application for Environmental Services to the Division of Ground Water Protection.

DATE: 2-3-09 SIGNATURE: James King AMOUNT PAID: \$ 100.00 RECEIPT NUMBER 60766

White: File

Canary: Owner



**TENNESSEE DEPARTMENT OF ENVIRONMENT AND CONSERVATION  
DIVISION OF GROUND WATER PROTECTION  
PERMIT FOR CONSTRUCTION OF SUBSURFACE SEWAGE DISPOSAL SYSTEM**

Issued to: <u>SABRINA BRAUNER</u> Owner, Developer, Contractor, Installer, Etc. Location: <u>146 GARDEN DRIVE</u> Installation: <input type="checkbox"/> 1. New Installation <input checked="" type="checkbox"/> 2. Repair to Existing System Establishment: <input checked="" type="checkbox"/> 1. Residential: # Bedrooms <u>REPAIR</u> <input type="checkbox"/> 2. Other: _____ (specify) Gal/Day _____	Evaluation Based Upon: <input type="checkbox"/> 1. Soil typing by Soil Scientist <input type="checkbox"/> a. General <input type="checkbox"/> b. High Intensity <input type="checkbox"/> c. Extra High Intensity <input type="checkbox"/> 2. Soil Percolation Test <input type="checkbox"/> 3. Environmental Specialist Estimated Absorption Rate: <u>REPAIR MPI</u> Approval based upon: Statute No. <u>T.C.A. 68-221-403</u> <input type="checkbox"/> (c) Percolation test <input type="checkbox"/> (d) Grandfather clause. Current standards except those specified <input type="checkbox"/> (f) 12" (karst) and 6" (non-karst) buffer required	Type of System: <input checked="" type="checkbox"/> 1. Conventional <input type="checkbox"/> 2. Low Pressure Pipe <input type="checkbox"/> 3. Mound <input type="checkbox"/> 4. Lagoon <input checked="" type="checkbox"/> 5. Large Diameter Gravelless Pipe <input type="checkbox"/> a. Sand backfill required <input type="checkbox"/> 6. Other  <input type="checkbox"/> (i) 9" buffer required (24"-36" total soil depth) <input type="checkbox"/> (k) Grandfather clause — meets June 30, 1990 standards (repair only) <input checked="" type="checkbox"/> Other <u>MEET REGS</u>
---	--	---

This system shall consist of a two compartment septic tank holding EXISTING gallons, with 200 ± linear feet in 3-5 trenches, 36 inches OR 18" wide and 24-26 inches deep. (Depth of gravel: 12 inches)

Also required:  
☐ 1. Soil Improvement Practice (SIP)  
☐ 2. Flow Diversion Valve  
☐ 3. Sewage Pump  
☐ 4. Other: \_\_\_\_\_

All installers of subsurface sewage disposal systems must hold a valid annual license from the Tennessee Department of Environment and Conservation.

The recipient of this permit agrees to construct or have constructed the above described system in accordance with T.C.A. 68-221-401 et. seq. and The Regulations To Govern Subsurface Sewage Disposal Systems. If any part of the system is covered before being inspected and approved, it shall be uncovered by the recipient of the permit at the direction of personnel of the Department of Environment and Conservation. Any cutting, filling or alterations of the soil conditions on the aforementioned property after this day may render this approval null and void.

☒ Charlie \_\_\_\_\_ Date 4-8-09  
 (Signature of Recipient)  
 Issued at LAFAYETTE Tennessee, in MAON County  
 By Ken Dikem EVSP III Date 04/08/09  
 (Name and Title) (Date of Issue)

This permit is valid for 3 years from date of issue.

Notes <u>FOR FINAL INSPECTION CALL</u> <u>666-8650 BETWEEN 8-9 AM MON-FRI</u> 1/ NOT TO SCALE 2/ INSTALL ON CONTOUR 3/ INSTALL FIELD LINES 10 FEET FROM PROPERTY LINES, STRUCTURES, + UNDERGROUND UTILITIES 4/ INSTALL FIELD LINES 50 FEET FROM ANY WATER SOURCE	
---	--

X Crossover  
 - - - SIP  
 - - - Field Line  
 Solid Line

This is a permit to construct and is not intended to imply approval of any work proposed or completed on this lot.





# CERTIFICATE OF COMPLETION OF SUBSURFACE SEWAGE DISPOSAL SYSTEM

Issued to: SABRINA BRAWNER  
Owner, Developer, Contractor, Installer, Etc.

Location: 146 GARDEN DRIVE

Type of system

- ( ) 1. Conventional  
( ) 2. Low Pressure Pipe  
( ) 3. Mound  
( ) 4. Lagoon  
(X) 5. Large Diameter Gravelless Pipe  
(a) Sand backfill required Yes ( ) No (X)

( ) 6. Other \_\_\_\_\_

EXISTING

Septic Tank

(type)

(volume)

Estimated Absorption Rate

REPAIR

(minutes per inch)

( ) New Installation

(X) Repair

( ) Other

Installed by:

TRENT

## TRENCHES

~~60~~ 40  
40

80' TOTAL

## GRADE SHOTS

1 <sup>ST</sup>	15.7	15.6	15.7
2 <sup>ND</sup>	14.9	14.9	14.9

NOT TO SCALE

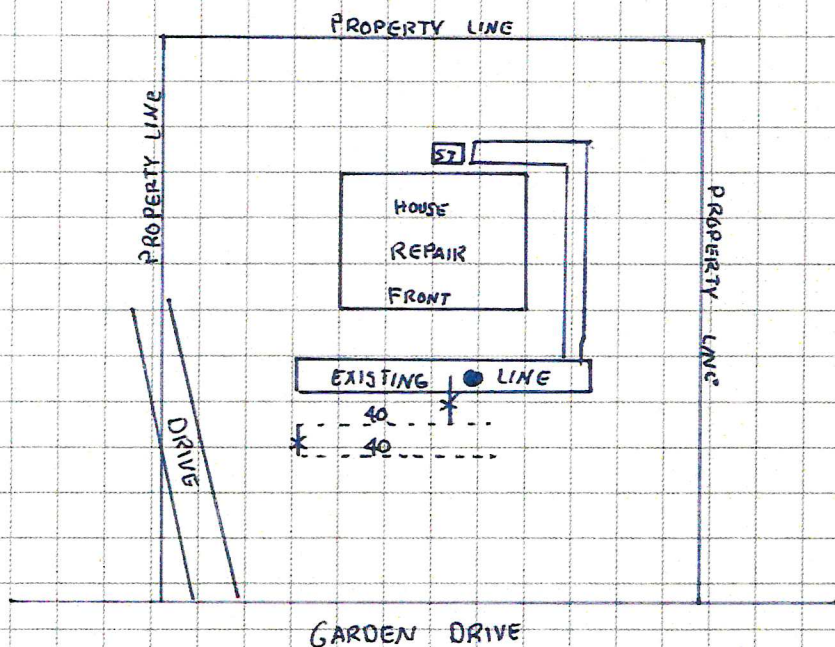

Construction Approved By:

Kevin Dink EVSP III  
(Name and Title)

04/08/09  
(date)