



Stunning Condo at Grand Junction

509 University Drive, Unit #112, Starkville, MS 39759



Walk to Campus? No Problem.

The Cotton District? Just steps away.

Main Street? Only a Block West.

Breakfast, Lunch, & Dinner? Take a look out your front door!

Adjacent to S.M.A.R.T. (Starkville MSU Area Rapid Transit) Pickup #22

<https://www.destinationgrandj.com>

Welcome to Unit 112 at 509 University Drive, a stunning Grand Junction condo in the heart of Starkville, MS. This 776-square-foot, one-bedroom, one-bathroom unit has soaring 12' ceilings and a beautiful open floorplan. The kitchen features granite countertops and stainless-steel appliances, perfect for culinary enthusiasts. The wood floors add warmth, while the custom walk-in shower and double vanity in the bathroom offer a spa-like experience. Smart technology, including a smartphone-controlled thermostat and door locks, ensures convenience and security. Enjoy your morning coffee on the private balcony and enjoy ample storage space throughout the unit. The condo includes a stackable washer/dryer combo and beautiful custom millwork. With private off-street parking, a fitness room, and secure building access, this condo offers comfort and peace of mind. Being sold fully furnished with all furnishings and kitchen supplies, it's truly turn-key ready. The association covers all exterior and common area maintenance, including cable, WiFi, pest control, and all utilities except electricity. Located steps from the vibrant Cotton District and Main Street and within walking distance of Mississippi State's campus, you'll have everything you need right at your doorstep. You can even enjoy the convenience of breakfast, lunch, and dinner options within the building. Take advantage of this opportunity to own a piece of Starkville's finest living. Schedule your viewing today and make Unit 112 your new home or weekend getaway!



**HALEY
BELDEN**

REALTOR®

Office: 601.898.2772

Cell: 601.209.2310

Haley@TomSmithHomes.com



Expect More. Get More.

A Real Estate Expert You Can Trust

TomSmithLandandHomes.com

Information is believed to be accurate but not guaranteed.





**A Real Estate Expert
You Can Trust!**

HALEY BELDEN
REALTOR®

O: 601.898.2772 C: 601.209.2310

Haley@TomSmithHomes.com

TomSmithLandandHomes.com



Expect More. Get More.



Information is believed to be accurate but not guaranteed.

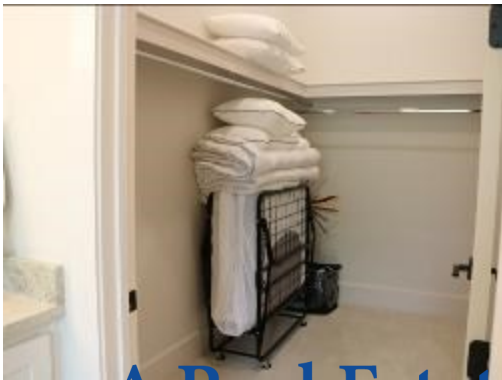

**A Real Estate Expert
You Can Trust!**

HALEY BELDEN

REALTOR®

O: 601.898.2772 C: 601.209.2310

Haley@TomSmithHomes.com

TomSmithLandandHomes.com



Expect More. Get More.



Information is believed to be accurate but not guaranteed.



A Real Estate Expert You Can Trust!

HALEY BELDEN
REALTOR®

O: 601.898.2772 C: 601.209.2310

Haley@TomSmithHomes.com

TomSmithLandandHomes.com



Expect More. Get More.



Information is believed to be accurate but not guaranteed.



Aerial Map

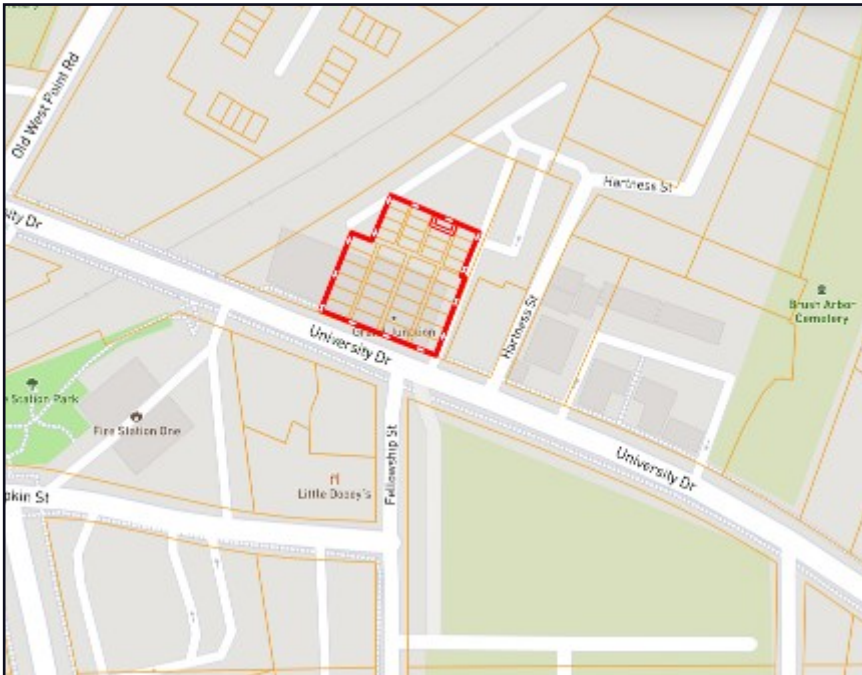

Ownership Map

**A Real Estate Expert
You Can Trust!**

HALEY BELDEN
REALTOR®

O: 601.898.2772 C: 601.209.2310

Haley@TomSmithHomes.com

TomSmithLandandHomes.com



Expect More. Get More.



Information is believed to be accurate but not guaranteed.

Directional Map

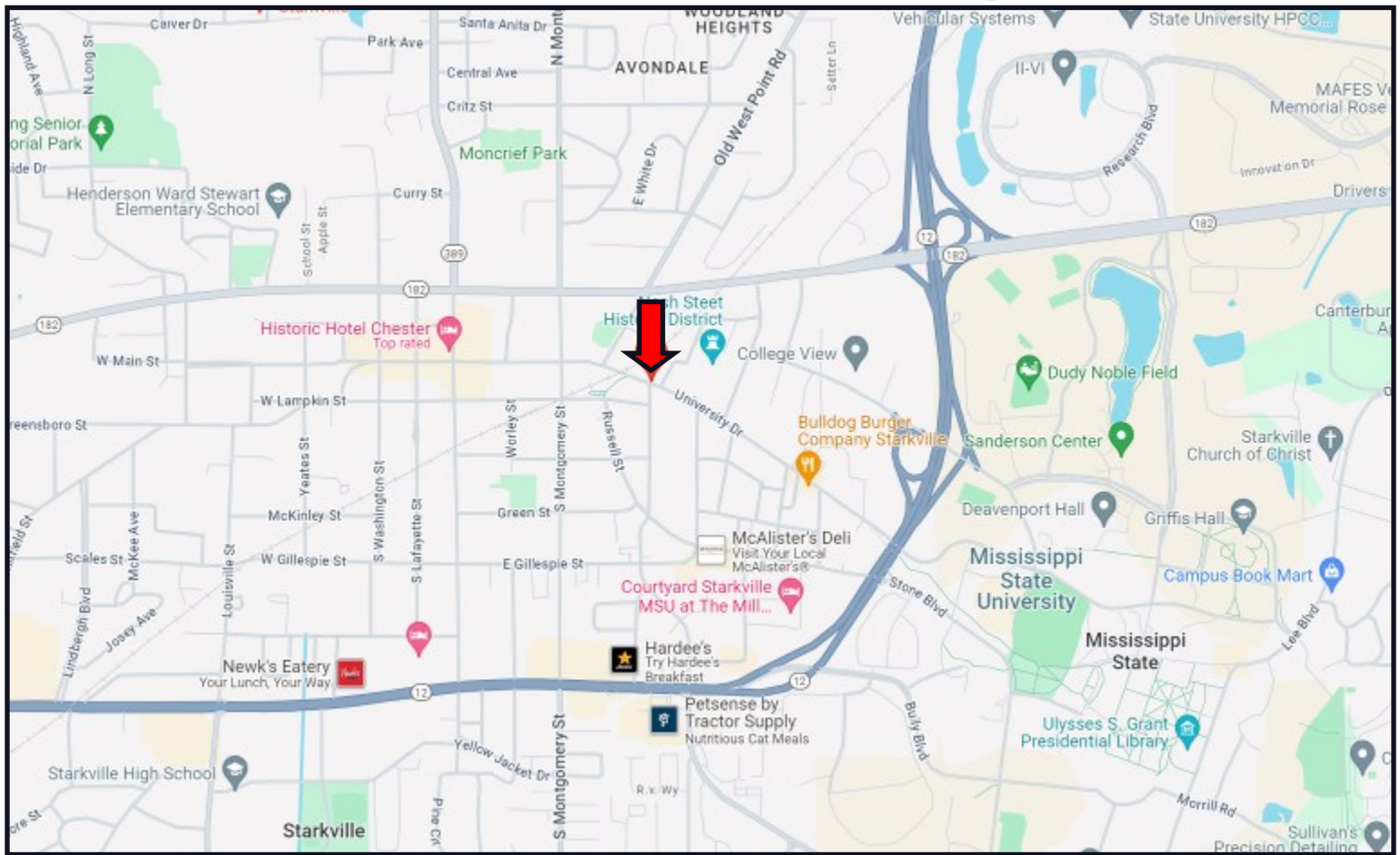

DIRECTIONS FROM THE INTERSECTION OF HWY 12 AND HWY 182 IN STARKVILLE, MS: Exit onto Hwy 182 W/Martin Luther King Jr. Dr. E and travel 0.6 miles. Turn left onto N Nash St. and travel 0.3 miles. Turn right onto University Drive. After 0.2 miles, the complex will be on your right, across from The Little Dooley.

509 UNIVERSITY AVENUE, STARKVILLE, MS 39759—GOOGLE MAP LINK



**HALEY
BELDEN**

REALTOR®

Office: 601.898.2772

Cell: 601.209.2310

Haley@TomSmithHomes.com



Expect More. Get More.

A Real Estate Expert You Can Trust

TomSmithLandandHomes.com

Information is believed to be accurate but not guaranteed.

