

Soils Map

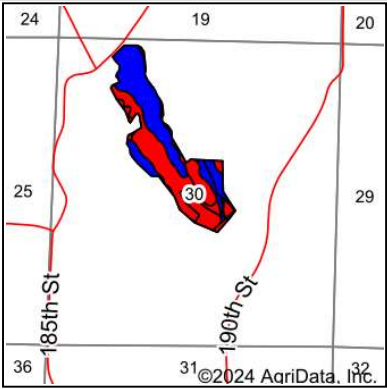

State: **Iowa**
County: **Pottawattamie**
Location: **30-77N-43W**
Township: **Boomer**
Acres: **54.84**
Date: **1/26/2024**

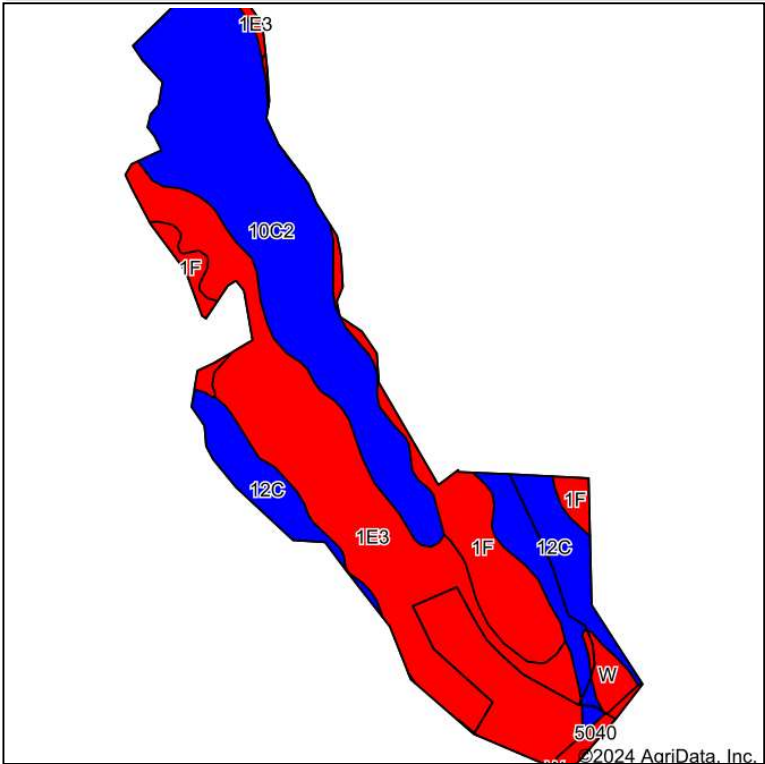

Soils data provided by USDA and NRCS.

Area Symbol: IA155, Soil Area Version: 29																
Code	Soil Description	Acres	Percent of field	CSR2 Legend	Non-Irr Class *c	*i Corn Bu	*i Soybeans Bu	CSR2**	CSR	Alfalfa hay Tons	Caucasian bluestem Tons	Common bermudagrass Tons	Orchardgrass red clover Tons	Tall fescue Tons	Warm season grasses Tons	*n NCCPI Soybeans
1E3	Ida silt loam, 14 to 20 percent slopes, severely eroded	20.81	37.9%	<div></div>	IVe	97.6	28.3	18	30							54
10C2	Monona silt loam, 5 to 9 percent slopes, eroded	18.30	33.4%	<div></div>	IIIe	211.2	61.2	86	63							76
12C	Napier silt loam, 5 to 9 percent slopes	7.68	14.0%	<div></div>	IIIe	214.4	62.2	89	62							87
1F	Ida silt loam, 20 to 30 percent slopes	6.62	12.1%	<div></div>	VIe	88.0	25.5	7	15	1	1	1	1	1	1	13
W	Water	0.88	1.6%	<div></div>		0.0	0.0	0	0							
5040	Udorthents, loamy	0.55	1.0%	<div></div>		88.0	25.5	5	5							
Weighted Average					*-	149	43.2	48.9	43	0.1	0.1	0.1	0.1	0.1	0.1	*n 59.6

Soils data provided by USDA and NRCS.

**IA has updated the CSR values for each county to CSR2.

**IA has updated the CSR values for each county to CSR2.*i Yield data provided by the ISPAID Database version 8.1.1 developed by IA State University.

*n: The aggregation method is "Weighted Average using all components"

**IA has updated the CSR values for each county to CSR2.*i Yield data provided by the ISPAID Database version 8.1.1 developed by IA State University.*c: Using Capabilities Class Dominant Condition Aggregation Method

**IA has updated the CSR values for each county to CSR2.*i Yield data provided by the ISPAID Database version 8.1.1 developed by IA State University.*c: Using Capabilities Class Dominant Condition Aggregation Method*- Non Irr Class weighted average cannot be calculated on the current soils data due to missing data.