

Soils Map

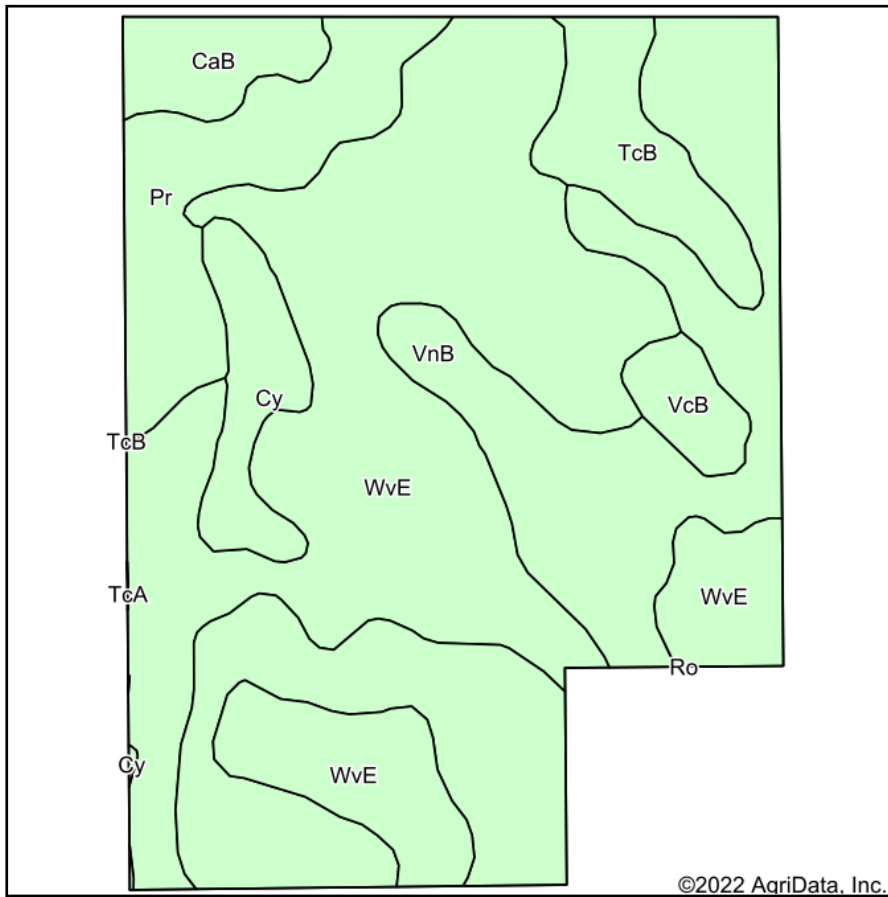

Soils data provided by USDA and NRCS.

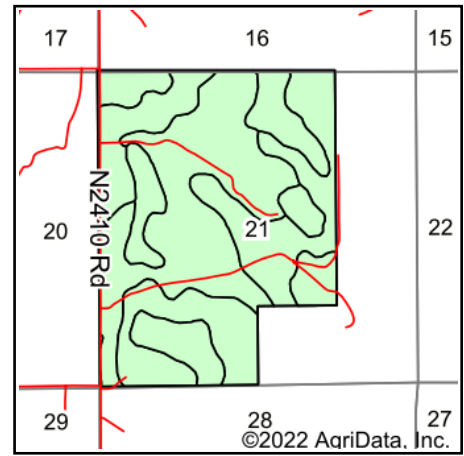

State: **Oklahoma**
 County: **Major**
 Location: **21-22N-14W**
 Township: **Fairview**
 Acres: **432.55**
 Date: **7/27/2022**



Maps Provided By:



Area Symbol: OK093, Soil Area Version: 16

Code	Soil Description	Acres	Percent of field	Water Table	Non-Irr Class *c	Irr Class *c	Range Production (lbs/acre/yr)	Cotton lint Lbs	Cotton lint Irrigated Lbs	Grain sorghum Bu	Grain sorghum Irrigated Bu	Wheat Bu	Wheat Irrigated Bu	*n NCCPI Overall	*n NCCPI Corn	*n NCCPI Small Grains	*n So
WvE	Burford-Vernon complex, 5 to 12 percent slopes	196.79	45.5%	> 6.5ft.	Ille	Ille	2895							38	28	25	
VnB	Knoco-Badland complex, 1 to 3 percent slopes	132.95	30.7%	> 6.5ft.	Vlls		650							12	9	8	
Pr	Port silt loam, 0 to 1 percent slopes, occasionally flooded	39.16	9.1%	> 6.5ft.	Ilw		6112							75	55	43	
TcB	Tillman clay loam, 1 to 3 percent slopes	22.31	5.2%	> 6.5ft.	Ile	Ile	1872	300	750	30	75	30	50	51	36	30	
Cy	Beckman clay, 0 to 1 percent slopes, frequently flooded	18.25	4.2%	4.5ft.	Vw		1890							25	21	21	
CaB	Canadian fine sandy loam, 1 to 3 percent slopes, rarely flooded	14.02	3.2%	> 6.5ft.	I	I	3318							45	38	31	
VcB	Vernon clay loam, 0 to 3 percent slopes	9.07	2.1%	> 6.5ft.	Ills		1700							23	16	17	
Weighted Average					4.11	*-	2389.7	15.5	38.7	1.5	3.9	1.5	2.6	*n 33.4	*n 24.8	*n 21.5	

*n: The aggregation method is "Weighted Average using all components"

*c: Using Capabilities Class Dominant Condition Aggregation Method

*- Irr Class weighted average cannot be calculated on the current soils data due to missing data.

Soils data provided by USDA and NRCS.